

NOTES:

1. THE CONTRACTOR SHALL MODIFY EXISTING SPACE CUBICLE AT "MCC-B" SWITCHBOARD TO PROVIDE ONE ADDITIONAL 40A TP&N MCCB FEEDER SWITCH FOR NEW MCB BOARD "DB-NEAC" IN TEMPORARY MCS ROOM. THE MODIFICATION WORKS SHALL INCLUDE EXTENSION OF BUSBAR/CABLE AND ALL NECESSARY MATERIAL.
2. THE CONTRACTOR SHALL DESIGN THE FEASIBLE ROUTING OF CONDUIT/TRUNKING FOR NEW LUMINAIRES & POWER SUPPLIES.

LEGEND:

✕ CABLE CONTAINMENT NO LONGER REQUIRED

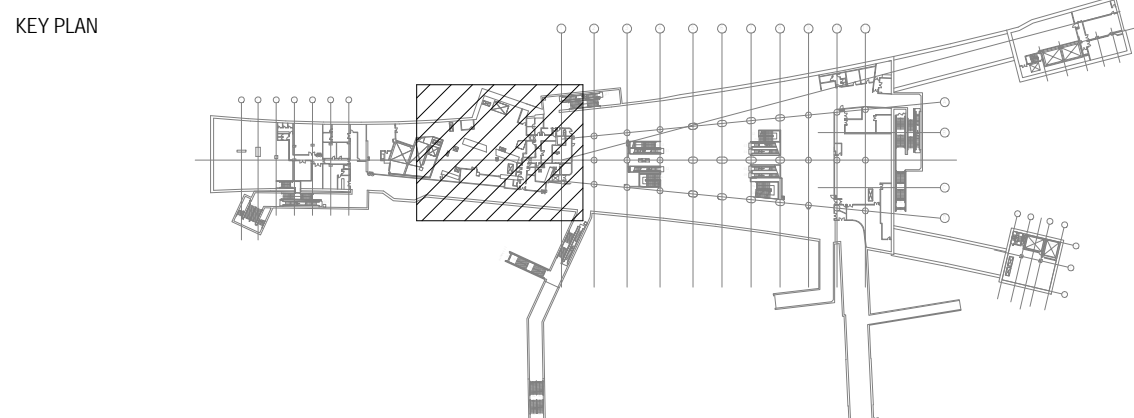

REV	DESCRIPTION	BY	DATE	APP	DO NOT SCALE DRAWINGS. ALL DIMENSIONS SHALL BE VERIFIED ON SITE. © MTR CORPORATION LIMITED 2008. COPYRIGHT IN RESPECT OF THIS DRAWING / DOCUMENT IS OWNED BY THE MTR CORPORATION LIMITED OF HONG KONG. NO REPRODUCTION OF THE DRAWING / DOCUMENT OR ANY PART BY WHATEVER MEANS IS PERMITTED WITHOUT THE PRIOR WRITTEN CONSENT OF THE MTR CORPORATION LIMITED.
B	REVISED AS PER 966 MCS ROOM NEW REQUIREMENT	WC	MAR 13	DF	
A	FIRST ISSUE	WC	DEC 12	DF	

DRAWN	
DESIGNED	
CHECKED	
APPROVED	
DATE	DEC 2012

ORIGINATOR	OPERATION DIVISION
BIM REF.	

TITLE	CS011.A-12E E&M SERVICES DIVERSION AND BUILDERS WORKS FOR PLATFORM WALL BREAK THROUGH AT ADM CONCOURSE - DOWN END (MCS EQUIPMENT ROOM) LIGHTING & SMALL POWER LAYOUT
SCALE	1:100(A1)
FIGURE NO.	E01/201
REV.	B

